

PLANNING DIMENSIONS

All dimensions in millimetres

Full overlay	K0	Half overlay	K8	Inset	K0	Mitred application	K0																																																																																																																																																																																																																																																			
<p>Mounting plate height 2</p> <table border="1"> <thead> <tr> <th>0</th> <th colspan="8">Cup distance</th> </tr> <tr> <th></th> <th>3</th> <th>4</th> <th>5</th> <th>6</th> <th>7</th> <th>8</th> <th colspan="2"></th> </tr> </thead> <tbody> <tr><td>21</td><td></td><td></td><td></td><td></td><td></td><td></td><td>0</td><td></td></tr> <tr><td>20</td><td></td><td></td><td></td><td></td><td></td><td>0</td><td></td><td></td></tr> <tr><td>19</td><td></td><td></td><td></td><td>0</td><td></td><td></td><td>2</td><td></td></tr> <tr><td>18</td><td></td><td></td><td>0</td><td></td><td>2</td><td>3</td><td></td><td></td></tr> <tr><td>17</td><td></td><td>0</td><td></td><td>2</td><td>3</td><td>4</td><td></td><td></td></tr> <tr><td>16</td><td>0</td><td></td><td>2</td><td>3</td><td>4</td><td></td><td></td><td></td></tr> <tr><td>15</td><td></td><td>2</td><td>3</td><td>4</td><td></td><td></td><td></td><td></td></tr> <tr><td>14</td><td>2</td><td>3</td><td>4</td><td></td><td></td><td></td><td></td><td></td></tr> <tr><td>13</td><td>3</td><td>4</td><td></td><td></td><td></td><td></td><td></td><td></td></tr> <tr><td>12</td><td>4</td><td></td><td></td><td></td><td></td><td></td><td></td><td></td></tr> <tr> <td>Door overlay</td> <td></td><td></td><td></td><td></td><td></td><td></td><td></td><td></td> </tr> <tr> <td></td> <td colspan="8">Mounting plate height</td> </tr> </tbody> </table>		0	Cup distance									3	4	5	6	7	8			21							0		20						0			19				0			2		18			0		2	3			17		0		2	3	4			16	0		2	3	4				15		2	3	4					14	2	3	4						13	3	4							12	4								Door overlay										Mounting plate height								<p>Mounting plate height 2</p> <table border="1"> <thead> <tr> <th>8</th> <th colspan="8">Cup distance</th> </tr> <tr> <th></th> <th>3</th> <th>4</th> <th>5</th> <th>6</th> <th>7</th> <th>8</th> <th colspan="2"></th> </tr> </thead> <tbody> <tr><td>13</td><td></td><td></td><td></td><td></td><td></td><td></td><td>0</td><td></td></tr> <tr><td>12</td><td></td><td></td><td></td><td></td><td></td><td>0</td><td></td><td></td></tr> <tr><td>11</td><td></td><td></td><td></td><td></td><td>0</td><td></td><td>2</td><td></td></tr> <tr><td>10</td><td></td><td></td><td></td><td>0</td><td></td><td>2</td><td>3</td><td></td></tr> <tr><td>9</td><td></td><td></td><td>0</td><td></td><td>2</td><td>3</td><td>4</td><td></td></tr> <tr><td>8</td><td>0</td><td></td><td>2</td><td>3</td><td>4</td><td></td><td></td><td></td></tr> <tr><td>7</td><td></td><td>2</td><td>3</td><td>4</td><td></td><td></td><td></td><td></td></tr> <tr><td>6</td><td>2</td><td>3</td><td>4</td><td></td><td></td><td></td><td></td><td></td></tr> <tr><td>5</td><td>3</td><td>4</td><td></td><td></td><td></td><td></td><td></td><td></td></tr> <tr> <td>Door overlay</td> <td></td><td></td><td></td><td></td><td></td><td></td><td></td><td></td> </tr> <tr> <td></td> <td colspan="8">Mounting plate height</td> </tr> </tbody> </table>		8	Cup distance									3	4	5	6	7	8			13							0		12						0			11					0		2		10				0		2	3		9			0		2	3	4		8	0		2	3	4				7		2	3	4					6	2	3	4						5	3	4							Door overlay										Mounting plate height								<p>Inset application</p> <p>With cranking 0, cup distance 3 mm and mounting plate height 18, you can achieve an inset application.</p> <p>Use 120° opening angle reduction clip.</p>		<p>Mitred application</p> <p>With cranking 0, cup distance 3 mm and a mounting plate height 18, you can achieve a mitred application.</p> <p>Use 120° opening angle reduction clip.</p>	
0	Cup distance																																																																																																																																																																																																																																																									
	3	4	5	6	7	8																																																																																																																																																																																																																																																				
21							0																																																																																																																																																																																																																																																			
20						0																																																																																																																																																																																																																																																				
19				0			2																																																																																																																																																																																																																																																			
18			0		2	3																																																																																																																																																																																																																																																				
17		0		2	3	4																																																																																																																																																																																																																																																				
16	0		2	3	4																																																																																																																																																																																																																																																					
15		2	3	4																																																																																																																																																																																																																																																						
14	2	3	4																																																																																																																																																																																																																																																							
13	3	4																																																																																																																																																																																																																																																								
12	4																																																																																																																																																																																																																																																									
Door overlay																																																																																																																																																																																																																																																										
	Mounting plate height																																																																																																																																																																																																																																																									
8	Cup distance																																																																																																																																																																																																																																																									
	3	4	5	6	7	8																																																																																																																																																																																																																																																				
13							0																																																																																																																																																																																																																																																			
12						0																																																																																																																																																																																																																																																				
11					0		2																																																																																																																																																																																																																																																			
10				0		2	3																																																																																																																																																																																																																																																			
9			0		2	3	4																																																																																																																																																																																																																																																			
8	0		2	3	4																																																																																																																																																																																																																																																					
7		2	3	4																																																																																																																																																																																																																																																						
6	2	3	4																																																																																																																																																																																																																																																							
5	3	4																																																																																																																																																																																																																																																								
Door overlay																																																																																																																																																																																																																																																										
	Mounting plate height																																																																																																																																																																																																																																																									

ZERO PROTRUSION

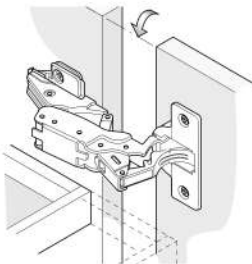

Zero protrusion for use with inset drawers.

With cranking 0 and mounting plate height 0, the door is flush with the cabinet at 90°.

MINIMUM GAP

Door thickness	Cup distance						
	3	4	5	6	8	10	
16	0.0	0.0	0.0	0.0	0.0	0.0	
18	0.0	0.0	0.0	0.0	0.0	0.0	
19	0.0	0.0	0.0	0.0	0.0	0.0	
20	0.0	0.0	0.0	0.0	0.0	0.0	
22	0.0	0.0	0.0	0.0	0.0	0.0	
23	0.0	0.0	0.0	0.0	0.0	0.0	
24	0.0	0.0	0.0	0.0	0.0	0.0	
25	0.0	0.0	0.0	0.0	0.0	0.0	
26	0.0	0.0	0.0	0.0	0.0	0.0	
	Minimum gap						

MINIMUM REVEAL

Door thickness	Cup distance						
	3	4	5	6	7	8	
16	0.0	0.0	0.0	0.0	0.0	0.0	
18	0.0	0.0	0.0	0.0	0.0	0.0	
19	0.0	0.0	0.0	0.0	0.0	0.0	
20	0.0	0.0	0.0	0.0	0.0	0.0	
22	0.0	0.0	0.0	0.0	0.0	0.0	
23	0.0	0.0	0.0	0.0	0.0	0.0	
24	0.0	0.0	0.0	0.5	1.8	2.0	
25	6.5	6.5	6.0	5.5	4.8	4.0	
26	10.5	9.5	8.5	7.5	6.5	5.5	
	Minimum reveal (F)						

NOTES

The minimum gap is the clearance required between the front edge of the cabinet and the closed door so that the door can be opened without hindrance.

**Important:** Reveals were determined with a (door) edge radius of 1 mm.

Hinge dimensions and reveal calculation with factory setting.

We recommend a trial fitting.

DRILLING PATTERNS

For screw fitting

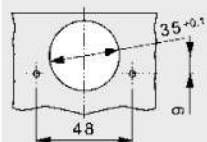

For press fitting

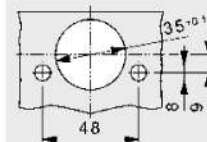

CUP DIMENSIONS

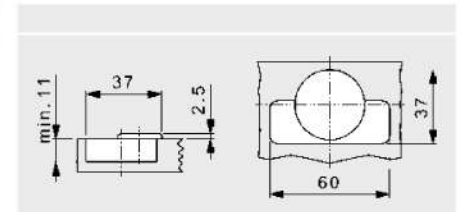

1  
2  
3  
4  
5  
6  
7  
8