

# TIOMOS 155

155° wide-angle hinge (door thicknesses up to 32 mm)

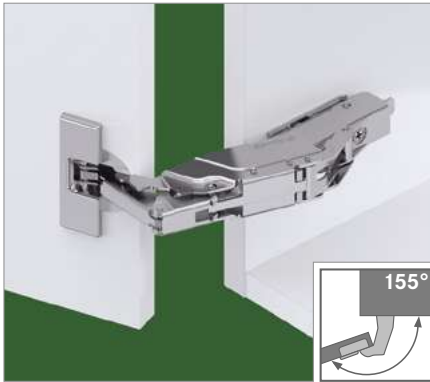

- 155° opening angle
- With convenient depth adjustment via worm screw
- For cabinets with inset drawers or pull-out shelves
- Optimal reveals for door thicknesses up to 32 mm
- 3-dimensional adjustment with corresponding mounting plate
- Minimum reveals
- Shallow cup depth
- Surfaces: Nickel or Night (especially for dark cabinet materials and woods)

### Available in three versions:

- With integrated damper (3 adjustable damping levels)
- Without integrated damper
- Without self-closing mechanism (without spring)

## ORDER INFORMATION FOR DRILLING PATTERN 45/9.5, NICKEL

Door overlay	Cranking	Damper		Without spring	Art. No.		
		With	Without		Click-on for screw fitting	Click-on for press fitting	Impresso tool-free
Full overlay <sup>1</sup>	0	■	-	-	<b>F028 138561</b>	<b>F028 138564</b>	<b>F017 139350</b>
		-	■	-	<b>F045 138499</b>	<b>F045 138502</b>	<b>F034 139321</b>
		-	■	■	<b>F046 138621</b>	<b>F046 138624</b>	-
Overlay <sup>1</sup>	3	■	-	-	<b>F028 138562</b>	<b>F028 138565</b>	<b>F017 139351</b>
		-	■	-	<b>F045 138500</b>	<b>F045 138503</b>	<b>F034 139322</b>
		-	■	■	<b>F046 138622</b>	<b>F046 138625</b>	-
Half overlay <sup>1</sup>	9.5	■	-	-	<b>F028 138563</b>	<b>F028 138566</b>	<b>F017 139352</b>
		-	■	-	<b>F045 138501</b>	<b>F045 138504</b>	<b>F034 139323</b>
		-	■	■	<b>F046 138623</b>	<b>F046 138626</b>	<b>F035 139380</b>

<sup>1</sup> Cup material: zamak, nickel-plated/Arm material: zamak, nickel-plated

## ORDER INFORMATION FOR DRILLING PATTERN 45/9.5, NIGHT

Door overlay	Cranking	Damper		Without spring	Art. No.		
		With	Without		Click-on for screw fitting		
Overlay <sup>1</sup>	3	■	-	-	<b>F028 140944</b>		
Half overlay <sup>1</sup>	9.5	■	-	-	<b>F028 140942</b>		

<sup>1</sup> Cup material: zamak, Night/Arm material: zamak, Night

### MITRED APPLICATION (ON ALL SIDES)

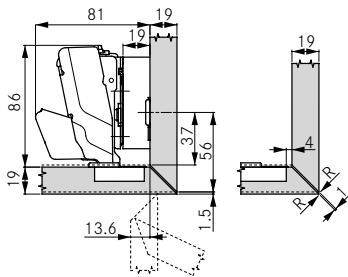

With 0 cranking, mounting plate height 19 mm and cup distance 4 mm, door and cabinet edges can meet at mitred angles on all 4 sides.

### ZERO PROTRUSION

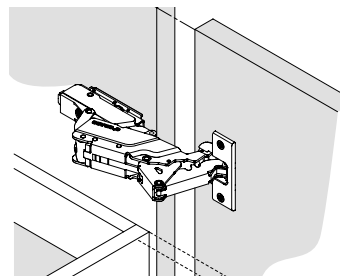

### For use with inset drawers.

At 0 cranking, and with all mounting plate thicknesses, the door protrudes inwards at 90°. With cranking size 3 and mounting plate height 3 mm, the door will be flush with the cabinet.

Door thickness (TS)	Mitre, all 4 sides	Mitre, side
	R (min.)	R (min.)
19-20	1.0	0
22	2.0	0
24	3.0	1.0
26	4.2	2.5
28	5.4	3.8
30	6.5	5.3

PLANNING DIMENSIONS

All dimensions in millimetres

Full overlay	K0	Overlay	K3	Half overlay	K9.5	Inset <sup>1</sup>	K0																																																																																																																																																																																																																																																																																																																																																																																																																																																																																																																	
Mounting plate height 2		Mounting plate height 2		Mounting plate height 2		Cranking 0, mounting plate height 21 <sup>1</sup> Set mounting plate back by door thickness + 1.5 mm																																																																																																																																																																																																																																																																																																																																																																																																																																																																																																																		
<table border="1"> <thead> <tr> <th rowspan="2">Door overlay</th> <th colspan="8">Cup distance</th> </tr> <tr> <th>3</th> <th>4</th> <th>5</th> <th>6</th> <th>7</th> <th>8</th> <th></th> <th></th> </tr> </thead> <tbody> <tr><td>25.0</td><td></td><td></td><td></td><td></td><td></td><td></td><td>-2</td><td></td></tr> <tr><td>24.0</td><td></td><td></td><td></td><td></td><td></td><td>-2</td><td></td><td></td></tr> <tr><td>23.0</td><td></td><td></td><td></td><td>-2</td><td></td><td>0</td><td></td><td></td></tr> <tr><td>22.0</td><td></td><td></td><td>-2</td><td></td><td>0</td><td></td><td></td><td></td></tr> <tr><td>21.0</td><td></td><td>-2</td><td></td><td>0</td><td>2</td><td></td><td></td><td></td></tr> <tr><td>20.0</td><td>-2</td><td></td><td>0</td><td>2</td><td>3</td><td></td><td></td><td></td></tr> <tr><td>19.0</td><td></td><td>0</td><td>2</td><td>3</td><td></td><td></td><td></td><td></td></tr> <tr><td>18.5</td><td></td><td></td><td></td><td></td><td></td><td></td><td></td><td></td></tr> <tr><td>18.0</td><td>0</td><td></td><td>2</td><td>3</td><td></td><td></td><td></td><td></td></tr> <tr><td>17.5</td><td></td><td></td><td></td><td></td><td></td><td></td><td></td><td></td></tr> <tr><td>17.0</td><td></td><td>2</td><td>3</td><td></td><td></td><td></td><td></td><td></td></tr> <tr><td>16.5</td><td></td><td></td><td></td><td></td><td></td><td></td><td></td><td></td></tr> <tr><td>16.0</td><td>2</td><td>3</td><td></td><td></td><td></td><td></td><td></td><td></td></tr> <tr><td>15.5</td><td></td><td></td><td></td><td></td><td></td><td></td><td></td><td></td></tr> <tr><td>15.0</td><td></td><td>3</td><td></td><td></td><td></td><td></td><td></td><td></td></tr> </tbody> </table>	Door overlay	Cup distance								3	4	5	6	7	8			25.0							-2		24.0						-2			23.0				-2		0			22.0			-2		0				21.0		-2		0	2				20.0	-2		0	2	3				19.0		0	2	3					18.5									18.0	0		2	3					17.5									17.0		2	3						16.5									16.0	2	3							15.5									15.0		3								<table border="1"> <thead> <tr> <th rowspan="2">Door overlay</th> <th colspan="8">Cup distance</th> </tr> <tr> <th>3</th> <th>4</th> <th>5</th> <th>6</th> <th>7</th> <th>8</th> <th></th> <th></th> </tr> </thead> <tbody> <tr><td>22.0</td><td></td><td></td><td></td><td></td><td></td><td></td><td>-2</td><td></td></tr> <tr><td>21.0</td><td></td><td></td><td></td><td></td><td></td><td>-2</td><td></td><td></td></tr> <tr><td>20.0</td><td></td><td></td><td></td><td></td><td>-2</td><td>0</td><td></td><td></td></tr> <tr><td>19.0</td><td></td><td></td><td></td><td>-2</td><td>0</td><td></td><td></td><td></td></tr> <tr><td>18.0</td><td></td><td>-2</td><td></td><td>0</td><td>2</td><td></td><td></td><td></td></tr> <tr><td>17.0</td><td>-2</td><td></td><td>0</td><td>2</td><td>3</td><td></td><td></td><td></td></tr> <tr><td>16.5</td><td></td><td></td><td></td><td></td><td></td><td></td><td></td><td></td></tr> <tr><td>16.0</td><td></td><td>0</td><td></td><td>2</td><td>3</td><td></td><td></td><td></td></tr> <tr><td>15.5</td><td></td><td></td><td></td><td></td><td></td><td></td><td></td><td></td></tr> <tr><td>15.0</td><td>0</td><td></td><td>2</td><td>3</td><td></td><td></td><td></td><td></td></tr> <tr><td>14.5</td><td></td><td></td><td></td><td></td><td></td><td></td><td></td><td></td></tr> <tr><td>14.0</td><td></td><td>0</td><td></td><td>2</td><td>3</td><td></td><td></td><td></td></tr> <tr><td>13.5</td><td></td><td></td><td></td><td></td><td></td><td></td><td></td><td></td></tr> <tr><td>13.0</td><td></td><td>2</td><td>3</td><td></td><td></td><td></td><td></td><td></td></tr> <tr><td>12.5</td><td></td><td></td><td></td><td></td><td></td><td></td><td></td><td></td></tr> <tr><td>12.0</td><td></td><td>3</td><td></td><td></td><td></td><td></td><td></td><td></td></tr> </tbody> </table>	Door overlay	Cup distance								3	4	5	6	7	8			22.0							-2		21.0						-2			20.0					-2	0			19.0				-2	0				18.0		-2		0	2				17.0	-2		0	2	3				16.5									16.0		0		2	3				15.5									15.0	0		2	3					14.5									14.0		0		2	3				13.5									13.0		2	3						12.5									12.0		3							<table border="1"> <thead> <tr> <th rowspan="2">Door overlay</th> <th colspan="8">Cup distance</th> </tr> <tr> <th>3</th> <th>4</th> <th>5</th> <th>6</th> <th>7</th> <th>8</th> <th></th> <th></th> </tr> </thead> <tbody> <tr><td>14.5</td><td></td><td></td><td></td><td></td><td></td><td>-2</td><td></td><td></td></tr> <tr><td>13.5</td><td></td><td></td><td></td><td></td><td>-2</td><td>0</td><td></td><td></td></tr> <tr><td>12.5</td><td></td><td></td><td></td><td>-2</td><td>0</td><td></td><td></td><td></td></tr> <tr><td>11.5</td><td></td><td>-2</td><td></td><td>0</td><td>2</td><td></td><td></td><td></td></tr> <tr><td>10.5</td><td>-2</td><td></td><td>0</td><td>2</td><td>3</td><td></td><td></td><td></td></tr> <tr><td>10.0</td><td></td><td></td><td></td><td></td><td></td><td></td><td></td><td></td></tr> <tr><td>9.5</td><td></td><td>0</td><td></td><td>2</td><td>3</td><td></td><td></td><td></td></tr> <tr><td>9.0</td><td></td><td></td><td></td><td></td><td></td><td></td><td></td><td></td></tr> <tr><td>8.5</td><td>0</td><td></td><td>2</td><td>3</td><td></td><td></td><td></td><td></td></tr> <tr><td>8.0</td><td></td><td></td><td></td><td></td><td></td><td></td><td></td><td></td></tr> <tr><td>7.5</td><td></td><td>2</td><td>3</td><td></td><td></td><td></td><td></td><td></td></tr> <tr><td>7.0</td><td></td><td></td><td></td><td></td><td></td><td></td><td></td><td></td></tr> <tr><td>6.5</td><td></td><td>2</td><td>3</td><td></td><td></td><td></td><td></td><td></td></tr> <tr><td>6.0</td><td></td><td></td><td></td><td></td><td></td><td></td><td></td><td></td></tr> <tr><td>5.5</td><td></td><td>3</td><td></td><td></td><td></td><td></td><td></td><td></td></tr> </tbody> </table>	Door overlay	Cup distance								3	4	5	6	7	8			14.5						-2			13.5					-2	0			12.5				-2	0				11.5		-2		0	2				10.5	-2		0	2	3				10.0									9.5		0		2	3				9.0									8.5	0		2	3					8.0									7.5		2	3						7.0									6.5		2	3						6.0									5.5		3							<table border="1"> <thead> <tr> <th rowspan="2">Door reveal</th> <th colspan="5">Cup distance</th> </tr> <tr> <th>3</th> <th>4</th> <th>5</th> <th></th> <th></th> </tr> </thead> <tbody> <tr><td>1.0</td><td>19</td><td></td><td>21</td><td></td><td></td></tr> <tr><td>1.5</td><td></td><td></td><td></td><td></td><td></td></tr> <tr><td>2.0</td><td></td><td></td><td>21</td><td></td><td></td></tr> <tr><td>3.0</td><td>21</td><td></td><td></td><td></td><td></td></tr> </tbody> </table>	Door reveal	Cup distance					3	4	5			1.0	19		21			1.5						2.0			21			3.0	21				
Door overlay		Cup distance																																																																																																																																																																																																																																																																																																																																																																																																																																																																																																																						
	3	4	5	6	7	8																																																																																																																																																																																																																																																																																																																																																																																																																																																																																																																		
25.0							-2																																																																																																																																																																																																																																																																																																																																																																																																																																																																																																																	
24.0						-2																																																																																																																																																																																																																																																																																																																																																																																																																																																																																																																		
23.0				-2		0																																																																																																																																																																																																																																																																																																																																																																																																																																																																																																																		
22.0			-2		0																																																																																																																																																																																																																																																																																																																																																																																																																																																																																																																			
21.0		-2		0	2																																																																																																																																																																																																																																																																																																																																																																																																																																																																																																																			
20.0	-2		0	2	3																																																																																																																																																																																																																																																																																																																																																																																																																																																																																																																			
19.0		0	2	3																																																																																																																																																																																																																																																																																																																																																																																																																																																																																																																				
18.5																																																																																																																																																																																																																																																																																																																																																																																																																																																																																																																								
18.0	0		2	3																																																																																																																																																																																																																																																																																																																																																																																																																																																																																																																				
17.5																																																																																																																																																																																																																																																																																																																																																																																																																																																																																																																								
17.0		2	3																																																																																																																																																																																																																																																																																																																																																																																																																																																																																																																					
16.5																																																																																																																																																																																																																																																																																																																																																																																																																																																																																																																								
16.0	2	3																																																																																																																																																																																																																																																																																																																																																																																																																																																																																																																						
15.5																																																																																																																																																																																																																																																																																																																																																																																																																																																																																																																								
15.0		3																																																																																																																																																																																																																																																																																																																																																																																																																																																																																																																						
Door overlay	Cup distance																																																																																																																																																																																																																																																																																																																																																																																																																																																																																																																							
	3	4	5	6	7	8																																																																																																																																																																																																																																																																																																																																																																																																																																																																																																																		
22.0							-2																																																																																																																																																																																																																																																																																																																																																																																																																																																																																																																	
21.0						-2																																																																																																																																																																																																																																																																																																																																																																																																																																																																																																																		
20.0					-2	0																																																																																																																																																																																																																																																																																																																																																																																																																																																																																																																		
19.0				-2	0																																																																																																																																																																																																																																																																																																																																																																																																																																																																																																																			
18.0		-2		0	2																																																																																																																																																																																																																																																																																																																																																																																																																																																																																																																			
17.0	-2		0	2	3																																																																																																																																																																																																																																																																																																																																																																																																																																																																																																																			
16.5																																																																																																																																																																																																																																																																																																																																																																																																																																																																																																																								
16.0		0		2	3																																																																																																																																																																																																																																																																																																																																																																																																																																																																																																																			
15.5																																																																																																																																																																																																																																																																																																																																																																																																																																																																																																																								
15.0	0		2	3																																																																																																																																																																																																																																																																																																																																																																																																																																																																																																																				
14.5																																																																																																																																																																																																																																																																																																																																																																																																																																																																																																																								
14.0		0		2	3																																																																																																																																																																																																																																																																																																																																																																																																																																																																																																																			
13.5																																																																																																																																																																																																																																																																																																																																																																																																																																																																																																																								
13.0		2	3																																																																																																																																																																																																																																																																																																																																																																																																																																																																																																																					
12.5																																																																																																																																																																																																																																																																																																																																																																																																																																																																																																																								
12.0		3																																																																																																																																																																																																																																																																																																																																																																																																																																																																																																																						
Door overlay	Cup distance																																																																																																																																																																																																																																																																																																																																																																																																																																																																																																																							
	3	4	5	6	7	8																																																																																																																																																																																																																																																																																																																																																																																																																																																																																																																		
14.5						-2																																																																																																																																																																																																																																																																																																																																																																																																																																																																																																																		
13.5					-2	0																																																																																																																																																																																																																																																																																																																																																																																																																																																																																																																		
12.5				-2	0																																																																																																																																																																																																																																																																																																																																																																																																																																																																																																																			
11.5		-2		0	2																																																																																																																																																																																																																																																																																																																																																																																																																																																																																																																			
10.5	-2		0	2	3																																																																																																																																																																																																																																																																																																																																																																																																																																																																																																																			
10.0																																																																																																																																																																																																																																																																																																																																																																																																																																																																																																																								
9.5		0		2	3																																																																																																																																																																																																																																																																																																																																																																																																																																																																																																																			
9.0																																																																																																																																																																																																																																																																																																																																																																																																																																																																																																																								
8.5	0		2	3																																																																																																																																																																																																																																																																																																																																																																																																																																																																																																																				
8.0																																																																																																																																																																																																																																																																																																																																																																																																																																																																																																																								
7.5		2	3																																																																																																																																																																																																																																																																																																																																																																																																																																																																																																																					
7.0																																																																																																																																																																																																																																																																																																																																																																																																																																																																																																																								
6.5		2	3																																																																																																																																																																																																																																																																																																																																																																																																																																																																																																																					
6.0																																																																																																																																																																																																																																																																																																																																																																																																																																																																																																																								
5.5		3																																																																																																																																																																																																																																																																																																																																																																																																																																																																																																																						
Door reveal	Cup distance																																																																																																																																																																																																																																																																																																																																																																																																																																																																																																																							
	3	4	5																																																																																																																																																																																																																																																																																																																																																																																																																																																																																																																					
1.0	19		21																																																																																																																																																																																																																																																																																																																																																																																																																																																																																																																					
1.5																																																																																																																																																																																																																																																																																																																																																																																																																																																																																																																								
2.0			21																																																																																																																																																																																																																																																																																																																																																																																																																																																																																																																					
3.0	21																																																																																																																																																																																																																																																																																																																																																																																																																																																																																																																							
Mounting plate height		Mounting plate height		Mounting plate height		Mounting plate height																																																																																																																																																																																																																																																																																																																																																																																																																																																																																																																		

MINIMUM GAP

Door thickness	Cup distance							
	3	4	5	6	7	8		
32.0	1.0	1.0						
31.0	1.0	1.0	1.0					
30.0	1.0	1.0	1.0					
29.0	1.0	1.0	1.0	1.0	1.0	1.0		
28.0	1.0	1.0	1.0	1.0	1.0	1.0		
26.0	1.0	1.0	1.0	1.0	1.0	1.0		
25.0	1.0	1.0	1.0	1.0	1.0	1.0		
24.0	1.0	1.0	1.0	1.0	1.0	1.0		
22.0	1.0	1.0	1.0	1.0	1.0	1.0		
21.0	1.0	1.0	1.0	1.0	1.0	1.0		
20.0	1.0	1.0	1.0	1.0	1.0	1.0		
18.0	1.0	1.0	1.0	1.0	1.0	1.0		
16.0	1.0	1.0	1.0	1.0	1.0	1.0		

MINIMUM REVEAL

Door thickness	Cup distance							
	3	4	5	6	7	8		
32.0	0.2	0.2						
31.0	0.2	0.2	0.2	0.2				
30.0	0.2	0.2	0.2	0.2	0.2			
29.0	0.2	0.2	0.2	0.2	0.2	0.2		
28.0	0.0	0.0	0.0	0.0	0.0	0.0		
26.0	0.0	0.0	0.0	0.0	0.0	0.0		
25.0	0.0	0.0	0.0	0.0	0.0	0.0		
24.0	0.0	0.0	0.0	0.0	0.0	0.0		
22.0	0.0	0.0	0.0	0.0	0.0	0.0		
21.0	0.0	0.0	0.0	0.0	0.0	0.0		
20.0	0.0	0.0	0.0	0.0	0.0	0.0		
18.0	0.0	0.0	0.0	0.0	0.0	0.0		
16.0	0.0	0.0	0.0	0.0	0.0	0.0		

■ Only possible with 120° angle reduction clip

NOTES

The minimum gap is the clearance required between the cabinet face and the closed door so that the door can be opened without hindrance.

Minimum reveal for doors with chamfered edges (R = 1 mm) with factory setting.

Up to door thickness 28 mm, no reveals are necessary. For door thicknesses from 29 mm, we recommend a trial fitting.

DRILLING PATTERNS 45/9.5

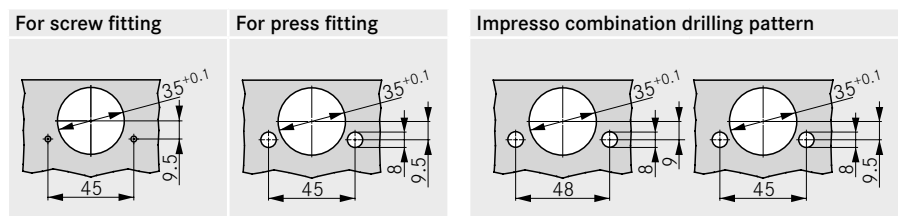

CUP DIMENSIONS

