

- Connecting fitting for sturdy, positive-fitting and friction-locked connections between shelves and side panels based on the proven eccentric latching principle
- Suitable for face layers from 3 mm
- For panel thicknesses from 45 - 60 mm
- The fitting is pressed into double holes with a drilling distance of 32 mm, 25 mm and 10 mm diameter insertion drilling holes.
- Only for mounting in edged lightweight panels
- Knock-in pin increases expanding action
- With optional rib as mounting aid
- Housing: plastic
- Eccentric: die-cast zinc

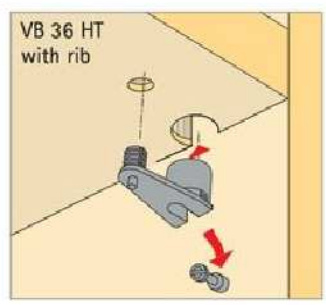

Fit shelf in position from above. Mounting aid when hanging shelves.

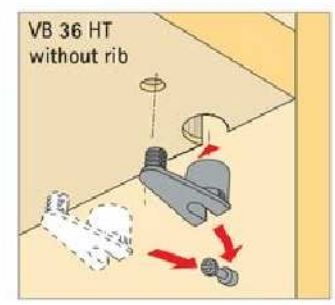

Fit shelf from above or the front

System 32

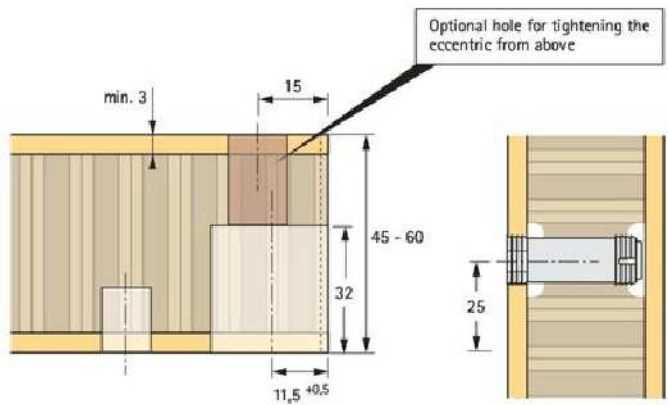
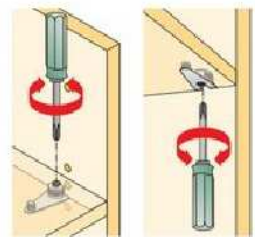
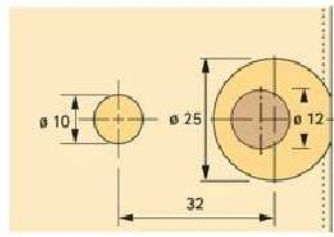

Finish	Order no. with rib	without rib	PU
black	9 066 391	9 066 390	1/200
grey	9 066 867	9 066 868	1/200
brown	9 078 246	9 078 249	1/200
white	9 078 245	9 078 248	1/200

For dowels, refer to pages 8.30 - 8.31



Cover cap for VB 36 HT
· Nickel-plated zinc die-cast

Order no.	PU
9 081 302	1/200

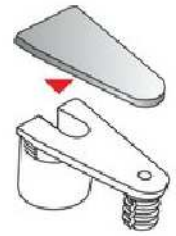

For dowels, refer to pages 8.30 - 8.31

The load capacity is determined by the quality of the lightweight panels used. Refer to page 8.20 for information on the pull-out values.